

## TECHNICAL DESCRIPTION

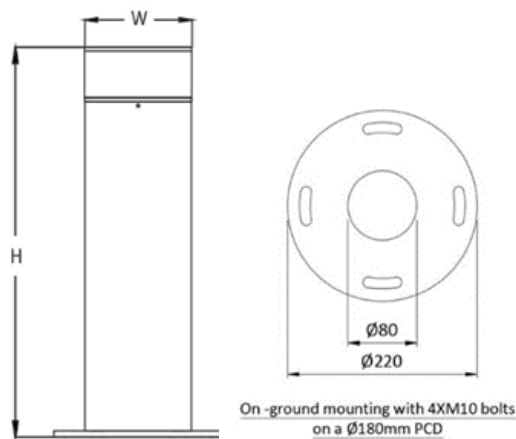

### DIMENSIONS



Model	Wattage (W)	Dimensions W x H (mm)
VIO	10	140 x 500
		140 x 770
		140 x 1000
VIO	18	140 x 500
		140 x 770
		140 x 1000

### APPLICATIONS

- Pathway
- Jogging track & Cycle track
- Green areas and parks
- Landscape areas

### DESCRIPTION (Tender text)

LED Bollard, BIS certified with a cadmium plated cylindrical steel pipe, permanently sealed optical block (IP66) with aluminium heat sink and a diffused (IK07) PMMA protector (optional IK10 PC protector).

Highly efficient symmetric light distribution providing excellent photometry to maximise the spacing between the bollards.

Suitable for on-ground mounting on 4xM10 bolts on 180mm PCD.

System power of 10W and 18W, Correlated colour temperature (CCT) of 4000K (optional 3000K & 5700K), colour rendering index (CRI) >70 and L70 rated lifetime of 50,000 hours.

Electrical Class I, rated voltage 240Vac, Power Factor  $\geq 0.95$ , with BIS certified potted driver having internal surge protection of 4/4 kV (in both Common & Differential Modes).

### CHARACTERISTICS

- Robust mechanical construction
- Maximised savings in energy and maintenance costs
- Easy to install
- Electrical class I
- Operating temperature range -10°C to 50°C.
- Operating Voltage Range: 240Vac
- Optional version available with a 180° light shield for a back-light control.
- Available in three different sizes for ground mounting on 4 x M10 bolts on 180mm PCD.
- Ingress Protection: IP66
- Impact resistance: IK07 (optional IK10)
- Optional concealed flange bottom mounting is also available. Special mounting tool shall be required to mount the bollard with concealed flange.

## RATING & EFFICACY

Catalogue Reference	Wattage (W)	CCT (K)	CRI	System Efficacy (Lm/W)
VIO-10W-500mm	10W	4000	> 70	55
VIO-10W-770mm	10W	4000	> 70	55
VIO-10W-1000mm	10W	4000	> 70	55
VIO-18W-500mm	18W	4000	> 70	55
VIO-18W-770mm	18W	4000	> 70	55
VIO-18W-1000mm	18W	4000	> 70	55

### Light Distributions

- The system efficacy & power consumption (wattage) of the luminaire are the values at 25°C ambient temperature, as initially tested and are dependent on environmental conditions, like temperature and may vary with specific configurations. Efficacy values are subject to  $\pm 5\%$  tolerance at rated voltage.
- Data subjected to change as we keep on adopting latest technologies to keep in sync with market, please consult us.
- Products for special application are also available, Please contact us for details.

### Concealed Flange Mounting

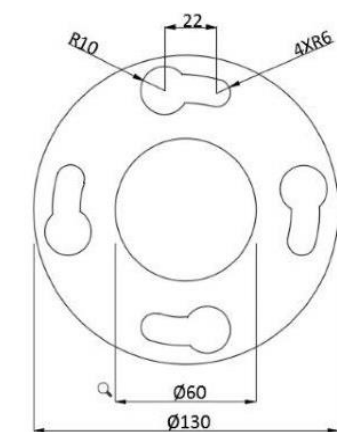

Concealed flange mounting with 4XM10 bolts  
on a Ø102mm PCD

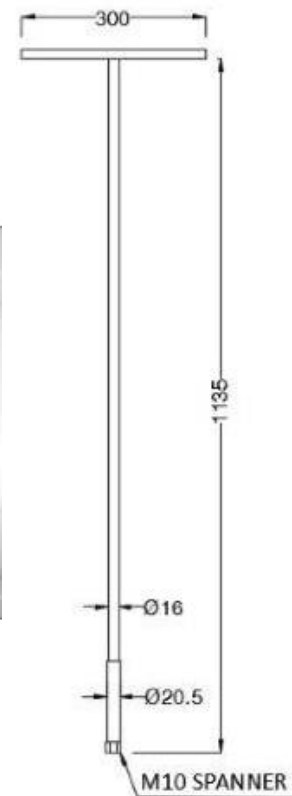

## KESELEC ORDERING CODE (KOC)

**EXAMPLE:** VI-010-40-R0-E2-SM-O0-P4-D0-S0-C0-T0-F10-L14

